

APPENDIX C

BY-LAW NUMBER 1990-3 of the CORPORATION OF THE
VILLAGE OF COBDEN

BEING a by-law to designate certain lands in the Village of Cobden as a Community Improvement Project Area pursuant to Section 28(2) of the Planning Act, 1983.

WHEREAS Section 28(2) of the Planning Act, 1983 provides that the Council of a Municipality that has an Official Plan in effect that contains provisions relating to community improvement may by by-law designate the whole or any part covered by such an Official Plan as a Community Improvement Project Area;

AND WHEREAS the lands hereinafter described as the Main Street Project Area are covered by the provisions in the Village of Cobden Official Plan pertaining to community improvement;

AND WHEREAS the Council of the Corporation of the Village of Cobden deems it in the interest of the Municipality to designate the aforesaid lands as a Community Improvement Project Area;

NOW, THEREFORE, BE IT ENACTED AND IT IS HEREBY ENACTED as a by-law of the Corporation of the Village of Cobden by the Council thereof as follows:

1. The lands outlined by a black solid line on Schedule "A" attached hereto and more particularly described in paragraph 3 shall hereinafter be known as the "Main Street Project Area".
2. The Main Street Project Area is hereby designated as a Community Improvement Project Area pursuant to the provisions of Section 28(2) of the Planning Act, 1983.
3. Schedule "A" attached hereto shall form part of this by-law.

By-Law read a first time this 24th day of January, 1990.

By-Law read a second time this 24th day of January, 1990

By-Law read a third time and finally passed this 24th day of January, 1990

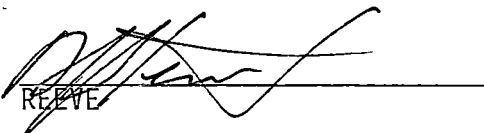
REEVE

CLERK-TREASURER

MAIN STREET PROJECT AREA

VILLAGE OF COBDEN
COUNTY OF RENFREW

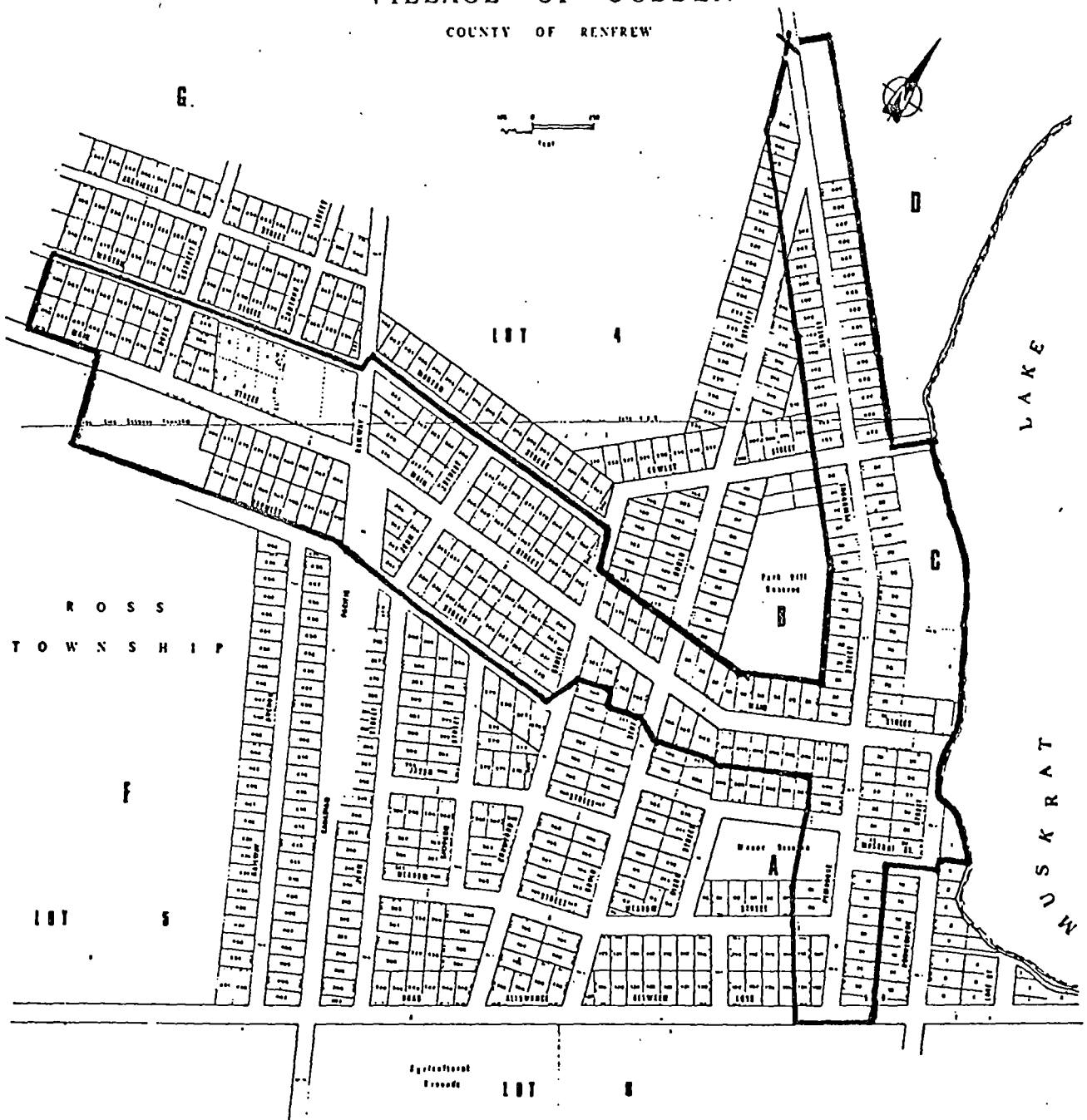

SCHEDULE A TO BY-LAW NO. 1990-3

JCS.
Clerk

[Signature]
Reeve

 groer, galloway & associates limited
CONSULTING ENGINEERS, PLANNERS
METROPOLITAN POLICE DISTRICT OF TORONTO

LEGEND

 Boundary of Community Improvement Project Area MAIN STREET PROJECT AREA

 Point of Commencement